



Flat 40, Riverside Court, 1 Chelwood Close

London

Guide Price **£155,000**



Flat 40

Riverside Court, London

This 1-bedroom retirement property in a peaceful community offers modern comfort with timeless charm. Ideal for over-60s, recently renovated to high standards. Features serene outdoor space and off-street parking. Ideal for tranquil living.

Council Tax band: C

Tenure: Leasehold

EPC Energy Efficiency Rating: C

EPC Environmental Impact Rating: D

- Recently Renovated
- Off Street Parking
- Over 60 Only



Floor Plan

Approx. 48.6 sq. metres (522.6 sq. feet)

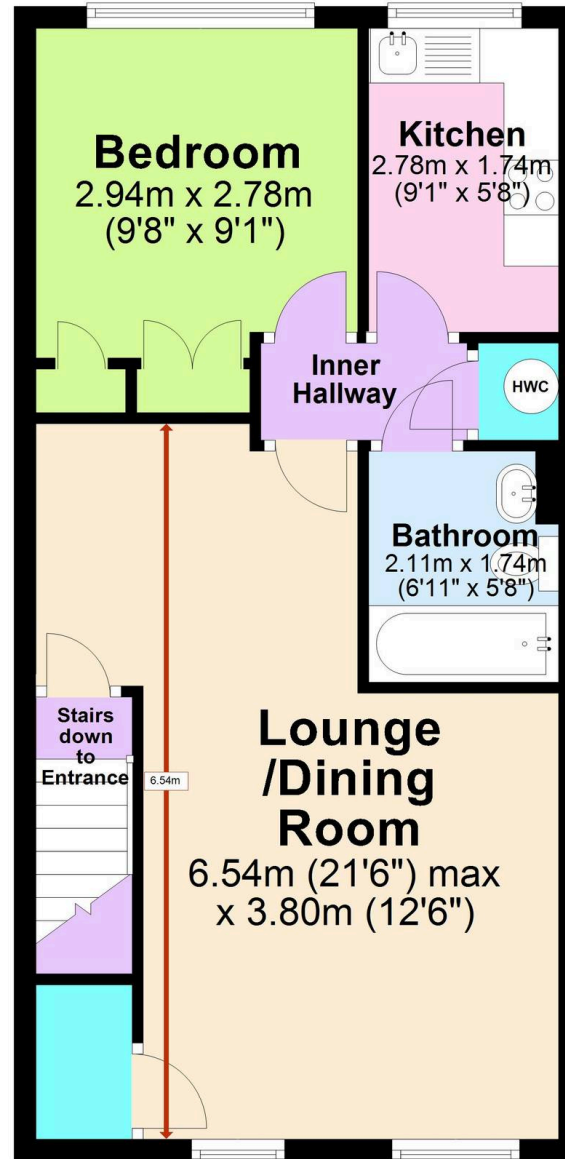

Total area: approx. 48.6 sq. metres (522.6 sq. feet)

Illustrations are for viewing purposes only. Measurements are not to scale.
Property Total and Floor Totals are internal figures only and do not include
Balconies, Garden, Patios or Terraces if shown. Floor Area of any
Outbuilding may be included in overall Total.
Plan produced using PlanUp.