



18 Hartland Road, London

London

Offers Over £565,000



18 Hartland Road

London, London

Council Tax band: C

Tenure: Freehold

EPC Energy Efficiency Rating: D

EPC Environmental Impact Rating: D



Ground Floor

Approx. 47.4 sq. metres (510.1 sq. feet)

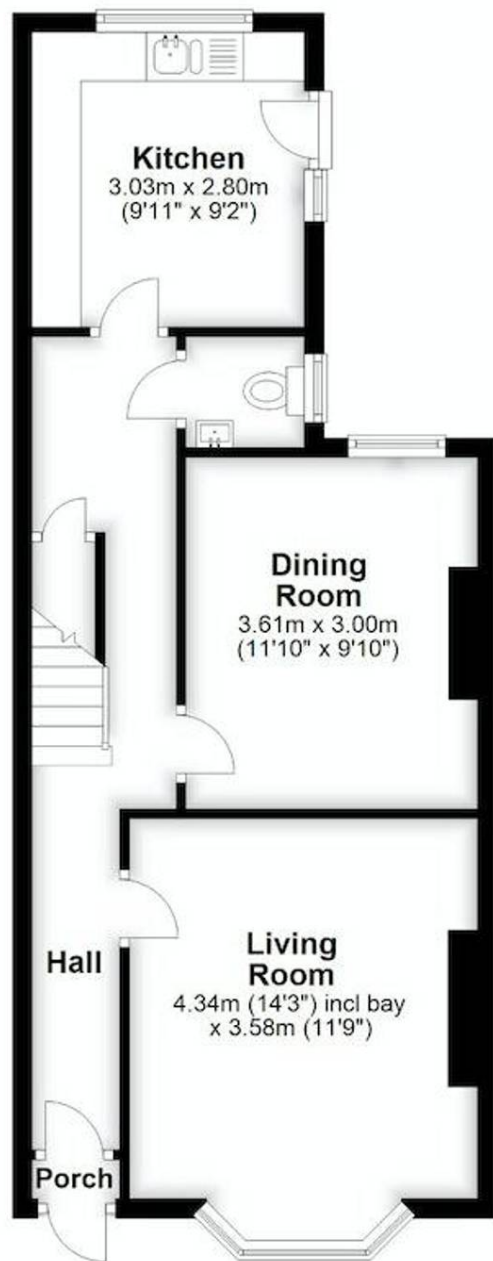

First Floor

Approx. 46.2 sq. metres (496.8 sq. feet)



Total area: approx. 93.5 sq. metres (1006.9 sq. feet)

MuuvPro - info@muuvpro.com / www.muuvpro.com / 01732 752199 - This plan is intended for marketing purposes and should be used as a guide only. Every effort is made to ensure its accuracy, however MuuvPro cannot accept liability for any errors or omissions.

Plan produced using PlanUp.